



--- --
POWERTRACK
L --- --

by  **Ten47**

INVEST - REUSE - REPEAT



POWERTRACK

A low level reusable temporary lighting and power system which requires no working at height, reduces trailing leads, creates zero waste and can be installed and modified by any competently trained person.

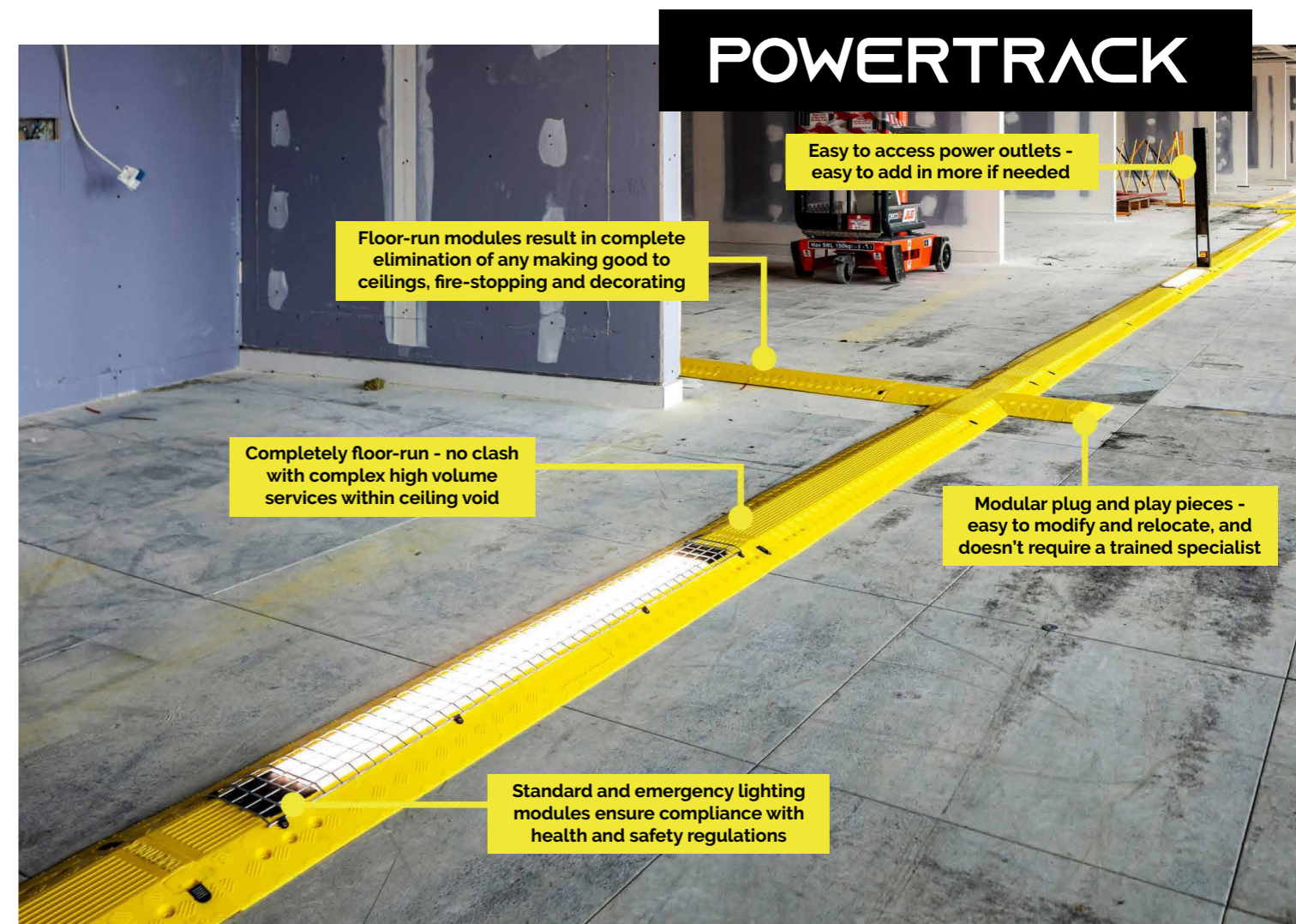
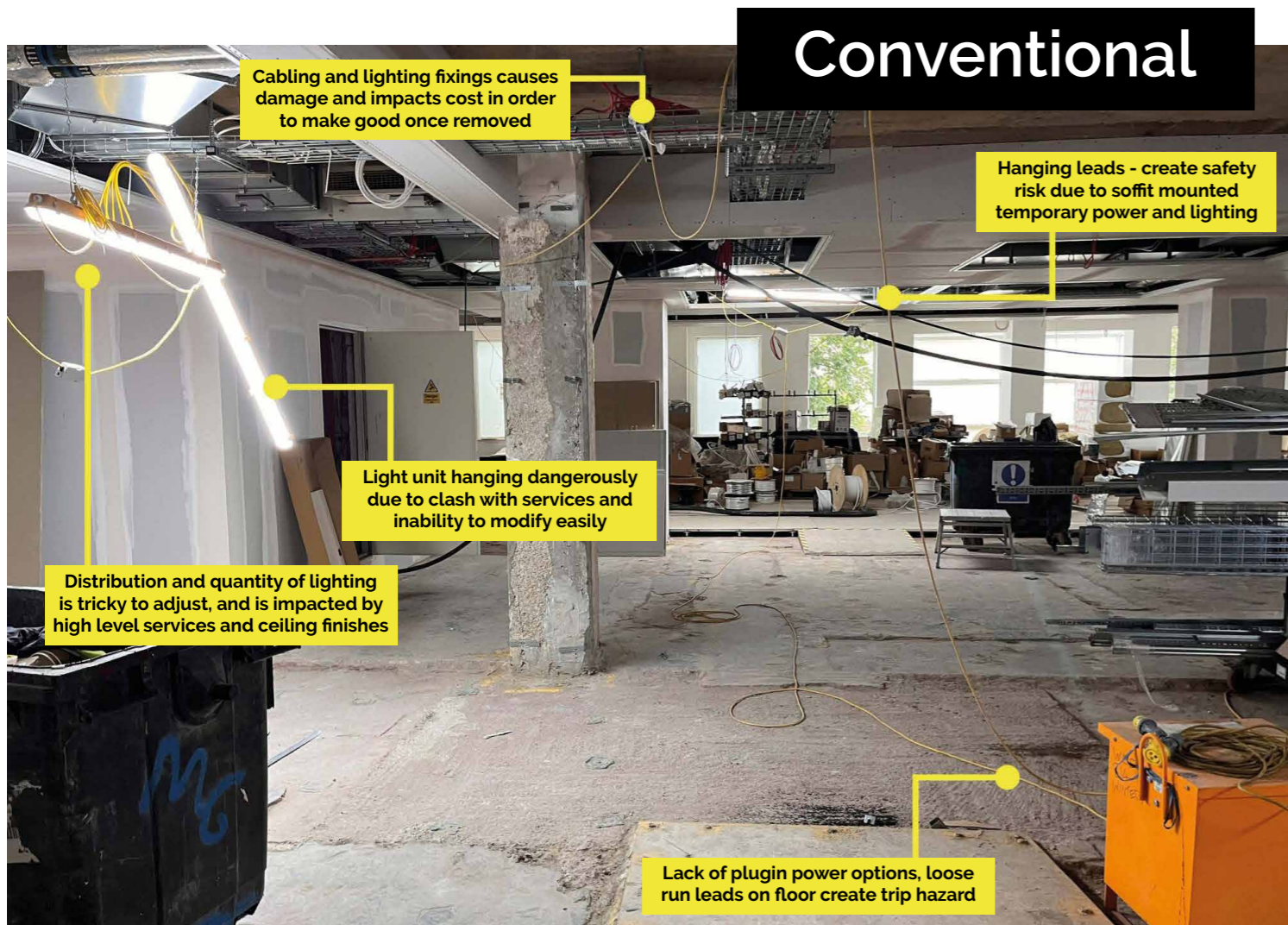

OUR MODULES



CORE
COLLECTION



Starter



Long Runner



Medium Runner



Short Runner

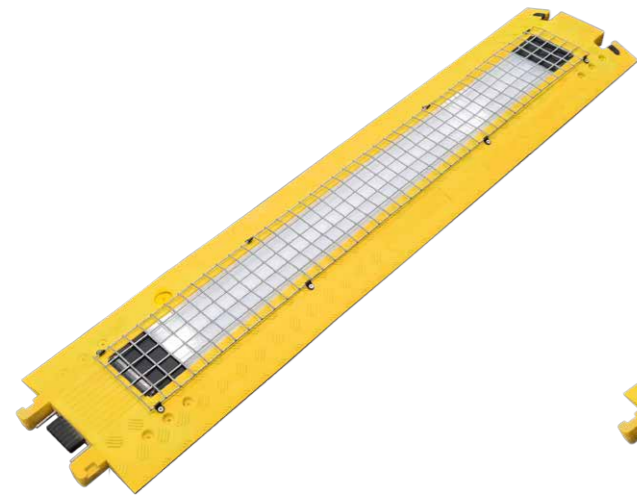

Lighting



Emergency Lighting



Power and Post



4-Way



Slinky

OUR MODULES



ACCESSORIES



Starter with Switch



Converter

(Powertrack to traditional 110v)



Reconverter

(Traditional 110v to Powertrack)



Power



Lighting Globe

(with connection piece)



Test Leads



End Cap

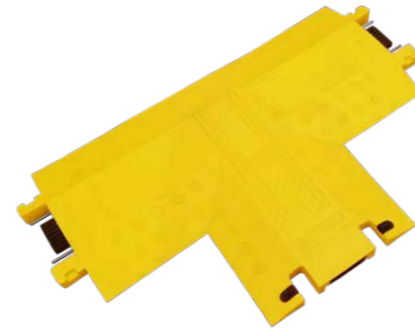

T Piece



Right Turn



Left Turn

LET'S LOOK A LITTLE CLOSER...

Up to max. 5000kg point load - withstands weight of heavy site equipment and vehicles

Personalised contact plate to suit customer requirements

Unique I.D. tag for all modules

Highly durable material made from high grade virgin polyurethane - fire, oil and paint resistant

Simple push-in, lock-in connection

Sloped sides to prevent trip hazards

6mm stainless steel guide pins protect the electrical connectors

IP65 and IPX2 rated electrical connection - dust tight and protected against low water pressure

Safety treads and bold colour for high visibility

Low profile only 29mm

End cap to avoid trip hazards and protect ends of track

RE-USE SERVICE

Our reuse service enables customers to own their site temps which we collect, store, repair and manage for you between projects.

You simply call us at the end of your project and we collect and store your modules for you. As you are due to start your next project we put a design together utilising your Powertrack stock and maximising your savings.

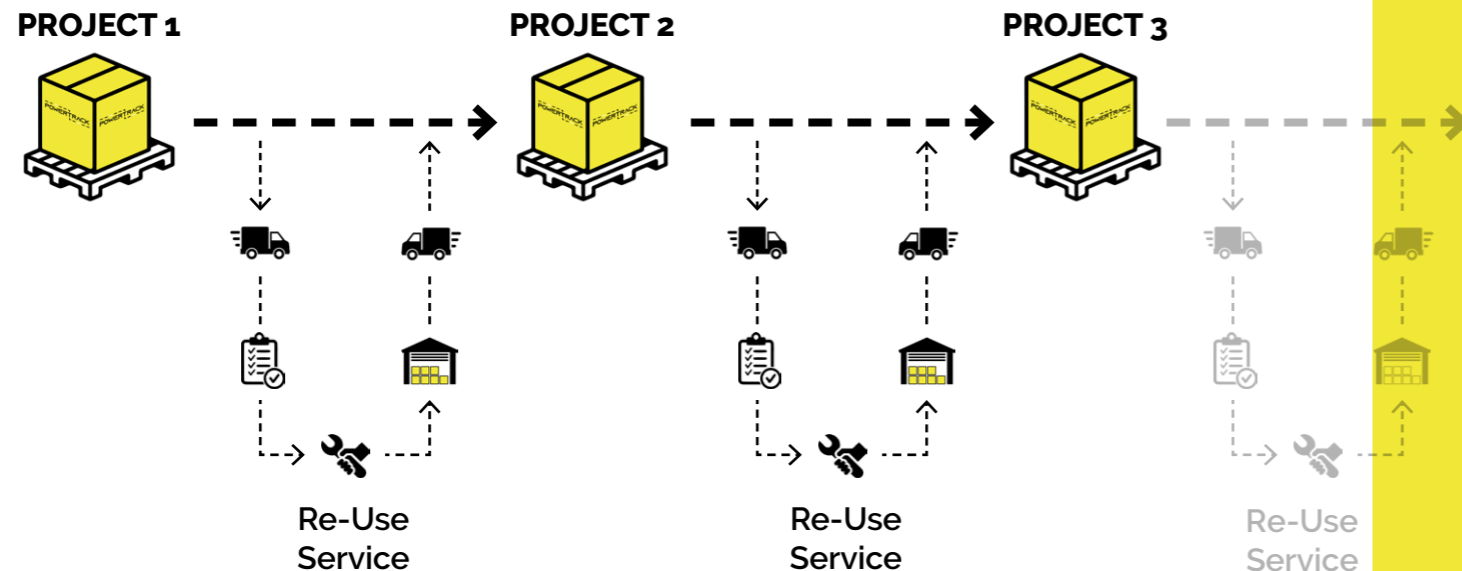
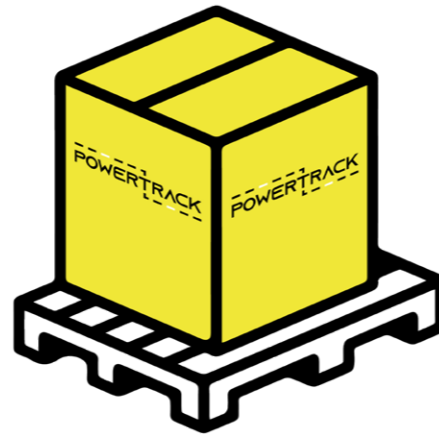

SAVING OF 62%

POWERTRACK MODULES ON THEIR 6TH PROJECT



Re-Use Service Cost: **£5 per module**

Based on 2,000 sqm projects (20,000 sqft)

SPEND OVER 5 PROJECTS

CONVENTIONAL

Project No.

- ① £6,400 plus 30% uplift* = **£8,300**
- ② £6,400 plus 30% uplift* = **£8,300**
- ③ £6,400 plus 30% uplift* = **£8,300**
- ④ £6,400 plus 30% uplift* = **£8,300**
- ⑤ £6,400 plus 30% uplift* = **£8,300**

Total Costs = **£41,600**

*due to variations

POWERTRACK

Project No.

- ① Lease with option to buy = **£6,400**
- ② Buy leased modules = **£6,400**
- ③ Re-use service = **£1,000**
- ④ Re-use service = **£1,000**
- ⑤ Re-use service = **£1,000**

Total Costs = **£15,800**

POWERTRACK COSTS

Split the cost of owning your Powertrack with our lease to purchase option. Lease Powertrack on your first project and own it by your 2nd project with your 3rd, 4th, 5th 6th and 7th Project costing less than £500.00 for our reuse service.

No variations, no call out costs, no down time just savings.

CUMULATIVE SPEND OVER 5 PROJECTS

CONVENTIONAL
 $\text{£}32,000 + \text{variations at } 30\% = \text{£}41,600$

POWERTRACK
 $\text{£}12,800 + \text{£}1000 \text{ per service} = \text{£}15,800$

= SAVING OF 62%

CONVENTIONAL SYSTEM VS. POWERTRACK

Based on 2,000 sqm projects (20,000 sqft)

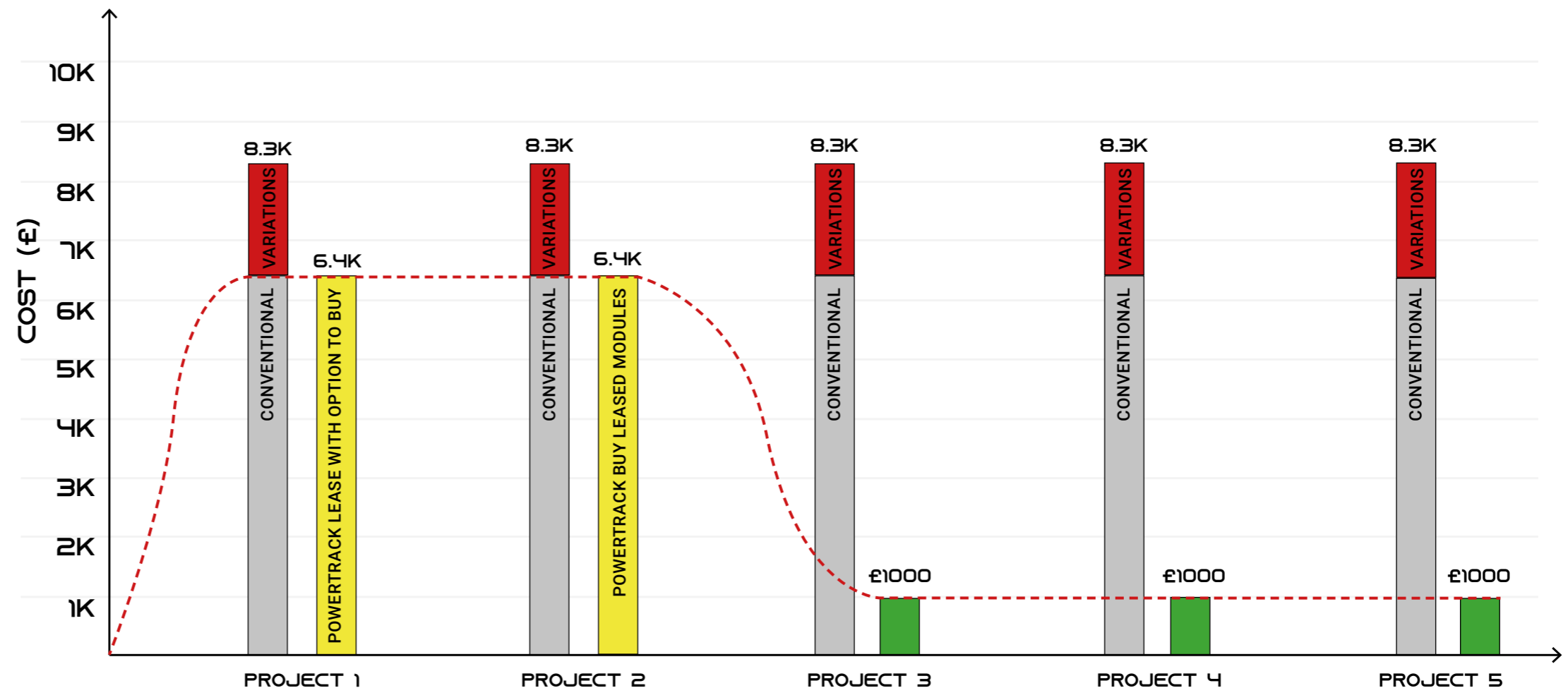

POWERTRACK DESIGN SERVICE

DESIGN SERVICE + QUOTATION

We offer a complementary design service through our in-house design team. All we need is your floor plan and we can layout your track and provide a quotation.

You send us:

- Floor plan in pdf with known measurement
- Temp power and lighting scope and specific project requirements (if any)

We send you:

A Powertrack design and cost proposal document with your layouts and a module breakdown within **48 hours!**

Total length of Powertrack per floor: 187 linear metres

Powertrack Modules Circuit 1 - 68 Metres

Powertrack Modules Circuit 2 - 66 Metres

Powertrack Modules Circuit 3 - 53 Metres

Recommended 10kVa Transformer Locations



Third floor proposed
Powertrack layout

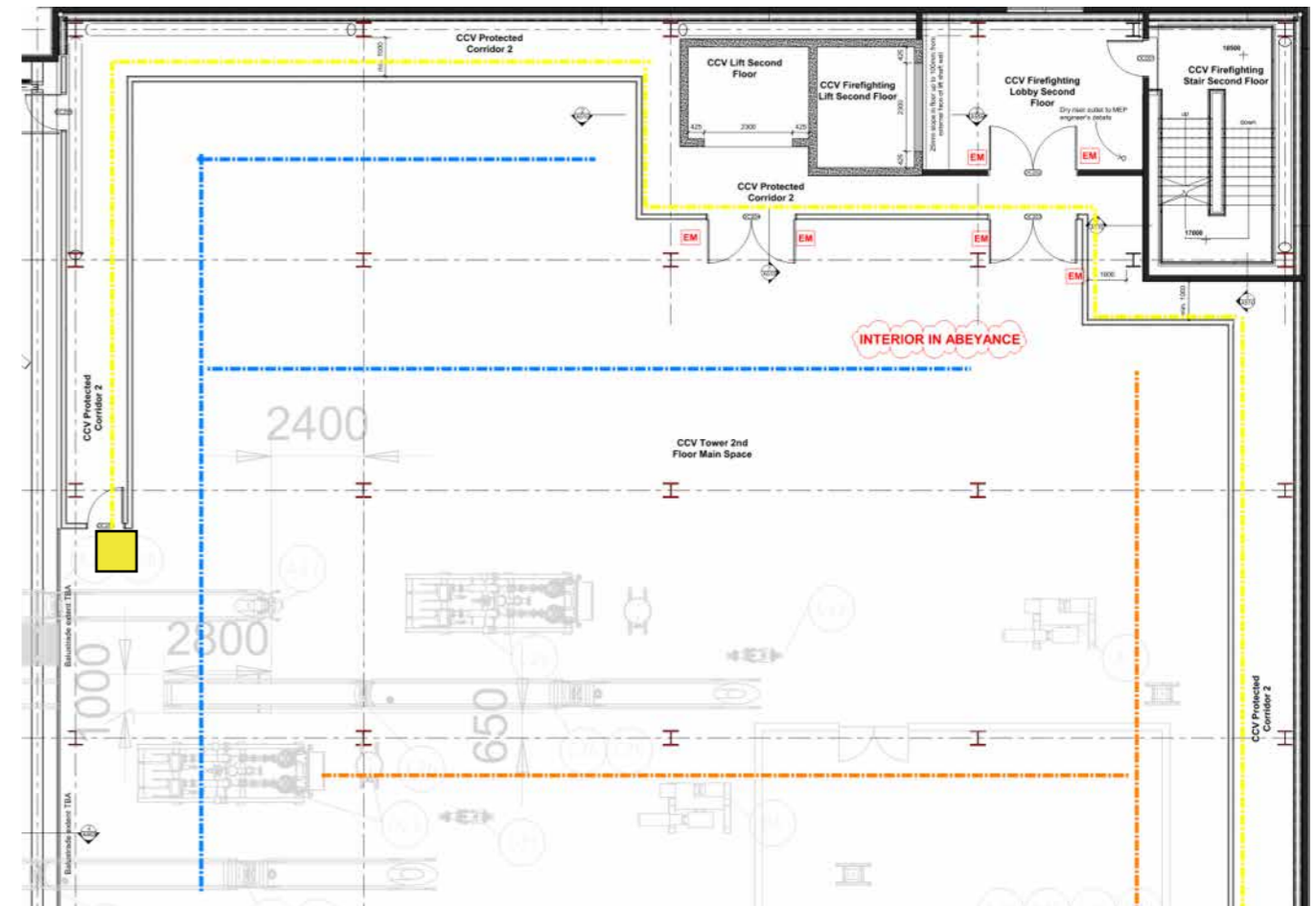

TECHNICAL DATA



Module/Accessory	Description	Length	Width	Height	Weight	IP Rating	Point Load	Lumen	Ampage	Voltage	Internal Cable Core Size	WARRANTY
Starter Without switch (PTFC00) With switch (PTFCS0)	Connects to a transformer and is the first module in a run of Powertrack.	200mm (not including leads)	258mm	29mm	1.9kg 2.2kg	IP65/IP2X	100kg	n/a	16amp	110v/240v	4mm power / 2.5mm lighting	3 years
Long Runner (PTE120)	Longest connecting module.	1200mm	258mm	29mm	5.7kg	IP65/IP2X	5000kg	n/a	16amp	110v/240v	4mm power / 2.5mm lighting	3 years
Medium Runner (PTE060)	Mid length connecting module.	600mm	258mm	29mm	3.4kg	IP65/IP2X	5000kg	n/a	16amp	110v/240v	4mm power / 2.5mm lighting	3 years
Short Runner (PTE020)	Shortest connecting module.	200mm	258mm	29mm	1kg	IP65/IP2X	5000kg	n/a	16amp	110v/240v	4mm power / 2.5mm lighting	3 years
Lighting (PTLS00WC)	Provides both safety and task lighting 30,00 hours LED life span.	1200mm	258mm	29mm	5.9kg	IP65/IP2X	300kg	2000	16amp	110v/240v	4mm power / 2.5mm lighting	2 years
Emergency Lighting (PTLE00WC)	Emergency enabled luminaire. 30,000 hours LED life span. Emergency back up 1 hour. Battery test and off switch to prevent battery drain down.	1200mm	258mm	29mm	6.2kg	IP65/IP2X	300kg	2000	16amp	110v/240v	4mm power / 2.5mm lighting	2 years
Power (PTPP00)	Power module providing 16amp female commando outlet.	200mm	258mm	29mm	1.6kg	IP65/IP2X	n/a	n/a	16amp	110v/240v	4mm power / 2.5mm lighting	3 years
Power Post (PTPP10)	Slides over top of Power module to avoid creating trip hazard.	86mm	86mm	900mm	0.75kg	n/a	n/a	n/a	n/a	n/a	n/a	3 years
4-Way (PTX000)	Facilitates connections for 4-way direction.	600mm	600mm	29mm	6.7kg	IP65/IP2X	5000kg	n/a	16amp	110v/240v	4mm power / 2.5mm lighting	3 years
Slinky (PTS000)	Provides flexibility to overcome change of levels and planning at any angle.	1000mm	258mm	29mm	3kg	IP65/IP2X	100kg	n/a	16amp	110v/240v	4mm power / 2.5mm lighting	3 years
Braided Slinky (PTSNV0)	This version of our slinky is for sharp changes of direction and is supplied with protective polyurethane braiding along its cabling.	1100mm	258mm	29mm	4.4kg	IP65/IP2X	100kg	n/a	16amp	110v/240v	4mm power + lighting	3 years
Converter - Powertrack to Traditional 110v (PTCM43)	Enables conversion from Powertrack to standard 110v leads.	200mm (not including leads)	258mm	29mm	1.9kg	IP65/IP2X	100kg	n/a	16amp	110v/240v	4mm power / 2.5mm lighting	3 years
Reconverter - Traditional 110v to Powertrack (PTCF43)	Enables conversion back from standard 110v leads to Powertrack.	200mm (not including leads)	258mm	29mm	1.9kg	IP65/IP2X	100kg	n/a	16amp	110v/240v	4mm power / 2.5mm lighting	3 years
Lighting Globe (PTGLSP0) - emergency version also available	Fits onto Power Post and connects to Power outlet to provide 360° light distribution.	n/a	190mm	252mm	1.8kg	IP54	n/a	2600	16amp	110v/240v	n/a	2 years
Test Leads (PTTL02)	Enables electrical testing of modules.	600mm	n/a	n/a	0.4kg	n/a	n/a	n/a	n/a	n/a	1.5mm power + lighting	1 year
Lighting and Power Test Leads (STNTLP)	Enables electrical testing of modules.	400mm	n/a	n/a	0.4kg	n/a	n/a	n/a	n/a	n/a	1.5mm power + lighting	1 year
End Cap (PTEC00)	Protects exposed ends of modules where needed.	150mm	258mm	29mm	0.75kg	IP65/IP2X	500kg	n/a	n/a	n/a	n/a	3 years
T Piece (PTT000)	Facilitates connection for T-arrangement.	600mm	450mm	29mm	5.5kg	IP65/IP2X	500kg	n/a	16amp	110v/240v	4mm power / 2.5mm lighting	3 years
Right / Left Turns (PTTP00)	Facilitates connection for right and left turns.	450mm	450mm	29mm	4kg	IP65/IP2X	500kg	n/a	16amp	110v/240v	4mm power / 2.5mm lighting	3 years

USING POWERTRACK



For every **1000m²** project,
Powertrack benefits include ...

(circa. 100 linear metres of Powertrack)

15 MINUTES

**INSTALLATION
TIME**

0 MINUTES

**DOWNTIME
FOR MODIFICATIONS**

30 MINUTES

**REMOVAL
TIME**

15 MINUTES

**TIME ARRANGING
POWERTRACK
CALL OFF AND DELIVERY**

0 NO.

**DAY WORK
SHEETS**

0 KG

**WASTE
CREATED**

£0.00

**VARIATION
ACCOUNT**

0 HOURS

**WORKING
AT HEIGHT**

£500

**COST OF POWERTRACK
ON NEXT PROJECT**

POWERTRACK

**YOU OWN IT
AND RE-USE IT.**

**WE COLLECT,
SERVICE AND
MANAGE IT.**

POWERTRACK | INVEST. RE-USE. REPEAT. YOU MAKE THE SAVINGS



CONTACTS



pwrtrack.com



powertrack@ten47.com



+44 (0)1592 321 111



search for  powertrack



by  Ten47

BRITISH PATENT NO. 1900563.6

BRITISH PATENT NO. 2013415.1

AUSTRALIAN PATENT NO. 2020210096

US PATENT NO. US1134926B2

INTERNATIONAL (PCT) PATENT NO. PCT/GB2020/050076

